

STAR WARS MILLENNIUM FALCON



FANHOM E

DeAgostini
COLLECTIBLES

Disney LUCASFILM

© & ™ 2025 LUCASFILM LTD.

A detailed view of the Starship's cargo bay, showing various equipment, including large circular structures and a prominent white curved beam of light.

A close-up photograph of a circular, segmented, metallic structure, possibly a component of a prosthetic or a specialized container, with a central circular opening. The structure is composed of many small, rectangular segments arranged in a ring. The central opening is a circular hole with a black and white checkered pattern. The entire structure is mounted on a dark, flat surface.

A large, highly detailed model of the Millennium Falcon, the iconic starship from the Star Wars franchise. The model is shown from a high-angle, three-quarter perspective, highlighting its complex, weathered metallic surface and numerous mechanical details. Key features include the circular sensor dome at the front, the large, rectangular main hull, and the various protrusions and panels that give it its unique, lived-in appearance. Several inset images are placed around the main model: a close-up of the cockpit area in the top left, a view of the ship's rear section in the top center, and a view of the ship's side profile in the bottom right. The background is a light gray grid pattern, and the overall presentation is clean and professional, typical of a product showcase for a high-quality replica.

ERA:	STAR WARS: <i>THE EMPIRE STRIKES BACK</i> (3 ABY)
SCALE:	1:43
DIMENSIONS:	LENGTH: 808 mm (32 in), WIDTH: 596 mm (23 in), HEIGHT: 192 mm (7.5 in)
WEIGHT:	APPROX. 11KG (24 lbs)
POWER REQUIRED:	SIX AA BATTERIES OR EXTERNAL 9V ADAPTER (SOLD SEPARATELY)

ERA:	STAR WARS: <i>THE EMPIRE STRIKES BACK</i> (3 ABY)
SCALE:	1:43
DIMENSIONS:	LENGTH: 808 mm (32 in), WIDTH: 596 mm (23 in), HEIGHT: 192 mm (7.5 in)
WEIGHT:	APPROX. 11KG (24 lbs)
POWER REQUIRED:	SIX AA BATTERIES OR EXTERNAL 9V ADAPTER (SOLD SEPARATELY)



BUILD THE *FALCON* AND DISCOVER ITS SECRETS

THE ULTIMATE AUTHENTIC REPLICA

Just like the *Falcon* from *Star Wars*: *The Empire Strikes Back*

Several models of the *Millennium Falcon* were used to make the *Star Wars* trilogy – but the most iconic was built for the action sequences in the second movie, *The Empire Strikes Back*. Your model is an authentic, official movie-accurate replica, built to the same scale, with all the external details seen on screen.

Its molded metal and resin construction make this ultimate *Millennium Falcon* replica easy to construct, with an unprecedented level of realism. And your model has the additional, unique feature that parts of the hull can be removed to reveal interior details seen in all three movies – including the cockpit, the main hold with its engineering station and hologame board, and Han Solo's smuggling compartments.

Pre-painted parts ensure an authentic appearance, but you can choose to add your own detailing. The finished model has working electronics, and can be wall- or table-mounted, with the landing legs and boarding ramp displayed up or down.

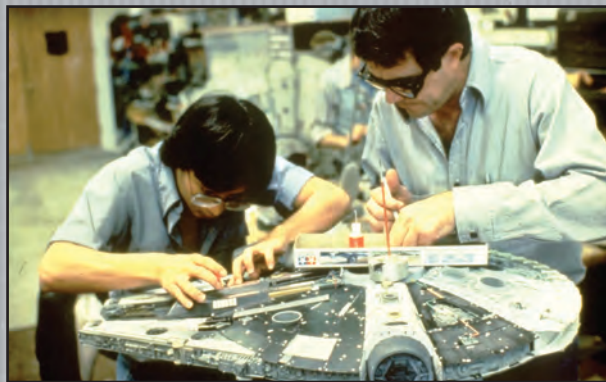

Discover how Industrial Light & Magic's model makers designed and built the many props and sets used to bring the *Falcon* to life on screen. This unique guide includes rare behind-the-scenes photography and revelations about the real story behind the movie magic.



Making your model

Your *Millennium Falcon* is easy to build from the high-quality metal and plastic parts provided with each issue. Simply follow the detailed step-by-step instructions in the magazine to assemble your own movie-accurate replica.

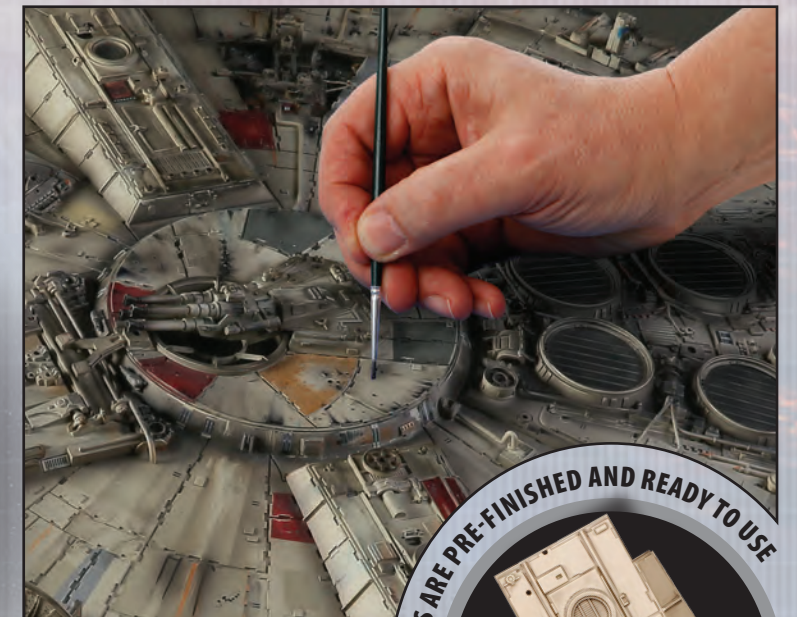

Hull parts are supplied pre-finished, but expert modelers can apply their own battle scars and other touches, to add extra authenticity and personalize the model.



INSIDE EVERY ISSUE OF *STAR WARS* MILLENNIUM *FALCON*

STARSHIP FACT FILE

Starting with the *Falcon*'s own fascinating story, explore the facts, figures and blueprints for the galaxy's key starships and spacecraft, including the X-wing, TIE fighter, Boba Fett's Starfighter, Star Destroyer, Death Star and many more. Includes exciting Mission Profiles, bringing each ship's story and abilities to life.



SECRETS OF SPACEFLIGHT

Discover the techniques of manufacturers and designers, from the Kuat Drive Yards to Koensayr. Explore the workings of systems, from repulsorlifts to hyperdrives – and the use of materials, from alantium to zwevel – to understand the magic of spaceflight and how *Star Wars* technology really works.

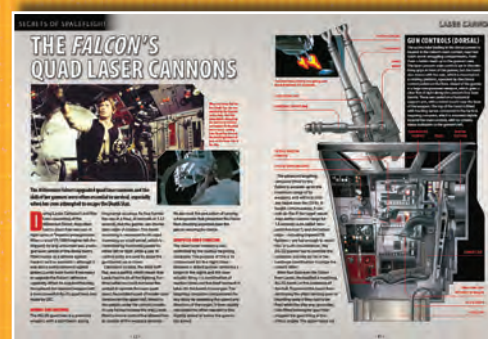

BUILD THE *FALCON*

This step-by-step guide shows you how to put together each issue's components. With parts made from materials that replicate the original perfectly, even beginners can achieve a completely authentic look, but there are also hints and tips to help expert modelers to add detailing, including all the real *Falcon*'s battle scars, wear and tear.

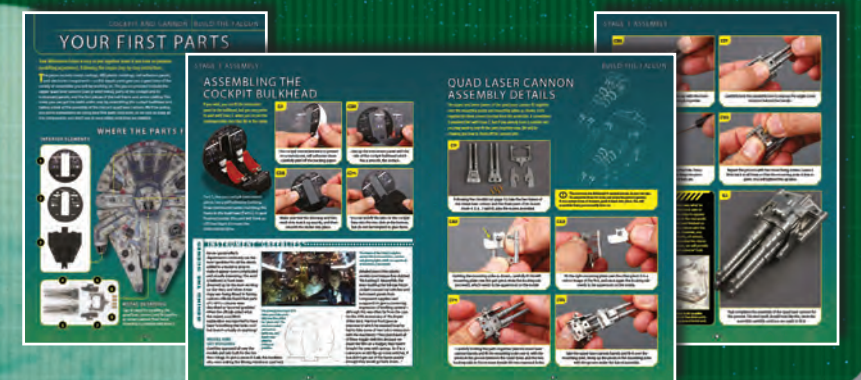

STAR WARS MILLENNIUM FALCON



© & ™ 2025 LUCASFILM LTD.